

FYTB 40 WF

Housing material

Cast iron

Dimensions

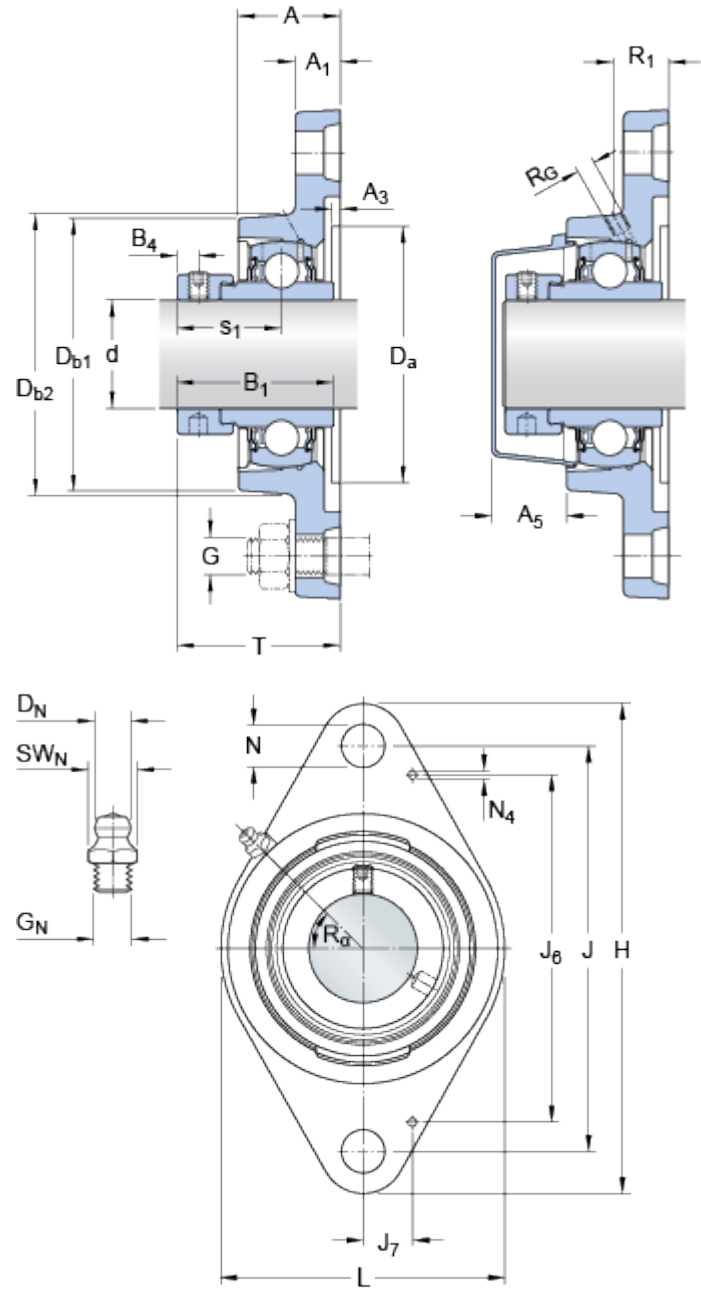

d	40	mm
D <sub>a</sub>	H11 88.9	mm
D <sub>b1</sub>	98	mm
D <sub>b2</sub>	102	mm
A	38.5	mm
A <sub>1</sub>	14	mm
A <sub>3</sub>	H14 3.2	mm
A <sub>5</sub>	23.5	mm
B <sub>1</sub>	56.3	mm
B <sub>4</sub>	6.75	mm
J	143.5	mm
H	171.5	mm
L	102	mm
N	14	mm
s <sub>1</sub>	34.9	mm
T	58.9	mm

Threaded hole

R <sub>G</sub>	1/4-28 UNF	
R <sub>1</sub>	24.5	mm
R <sub>α</sub>	45	°

Grease fitting

D <sub>N</sub>	6.5	mm
SW <sub>N</sub>	7	mm
G <sub>N</sub>	1/4-28 SAE-LT	

Dowel pins

J <sub>6</sub>	115.5	mm
----------------	-------	----

	J <sub>7</sub>	16	mm
	N <sub>4</sub>	2	mm
Calculation data			
Basic dynamic load rating	C	30.7	kN
Basic static load rating	C <sub>0</sub>	19	kN
Fatigue load limit	P <sub>u</sub>	0.8	kN
Limiting speed (with shaft tolerance h6)		4800	r/min
Mass			
Mass bearing unit		1.65	kg
Mounting information			
Thread grub screw	G <sub>2</sub>	M10x1	
Hexagonal key size for grub screw	N	5	mm
Recommended tightening torque for grub screw		16.5	N·m
Recommended diameter for attachment bolts, mm	G	12	mm
Recommended diameter for attachment bolts, inch	G	0.5	in
Included products			
Housing		FYTB 508 M	
Bearing		YEL 208-2F	
Assosiated products			
End cover		ECY 208	